

TILE OUTLET RIP-RAP DETAIL  
NTS

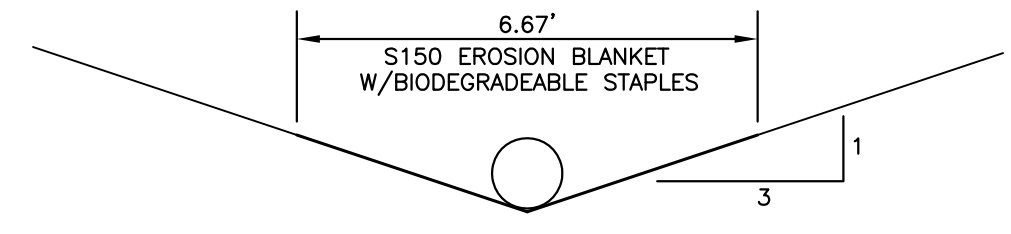

TILE OUTLET WATERWAY DETAIL  
NTS

			DODGE COUNTY DRAINAGE DISTRICT 88 BURNETT CORNERS DRAIN		
			DRAWN BY: DJP APPROVED: DJP SCALE: GRAPHIC	DATE: JULY 20, 2010 JOB NO.: dd88	SHEET: 1 OF 4
P.O. Box 293 Beaver Dam, WI 53916 (920) 887-3128 www.dteusa.com © 2012 DesignTech Engineering, LLC.					

REVISED 5/29/13 DJP

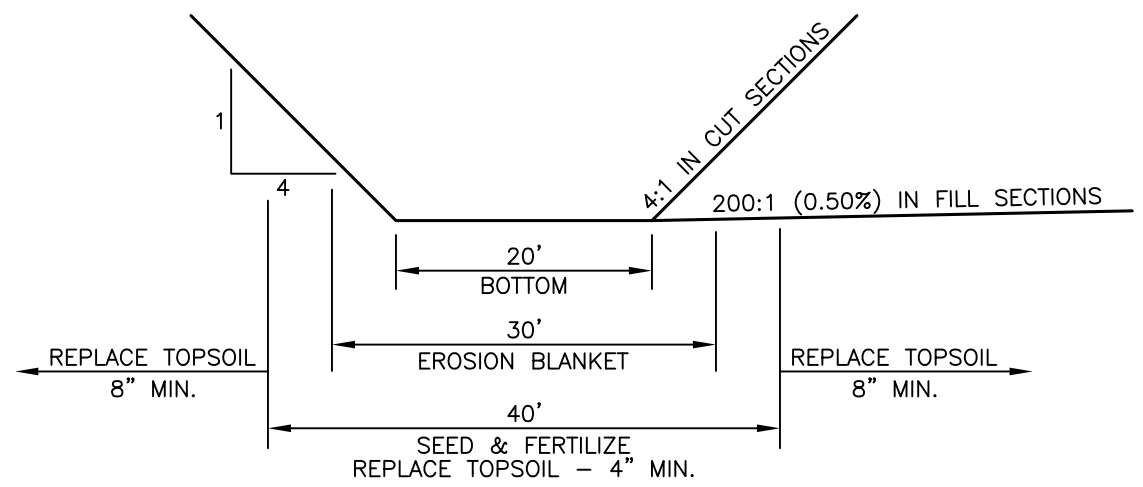
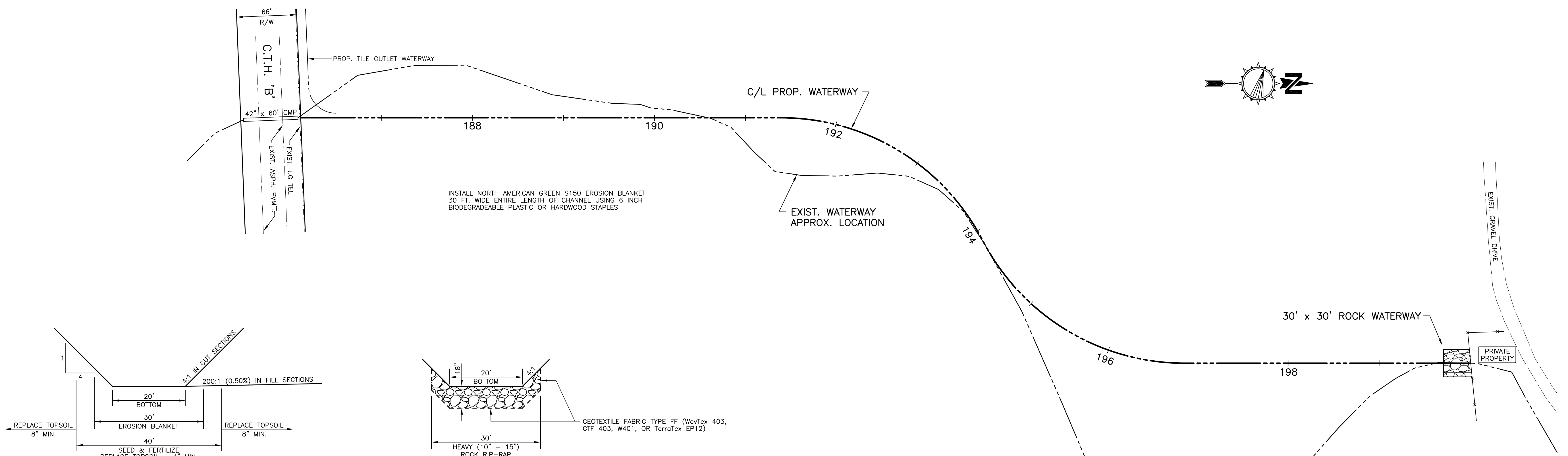
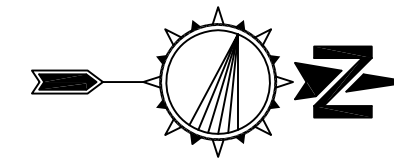

GRASS WATERWAY DETAIL  
NTS

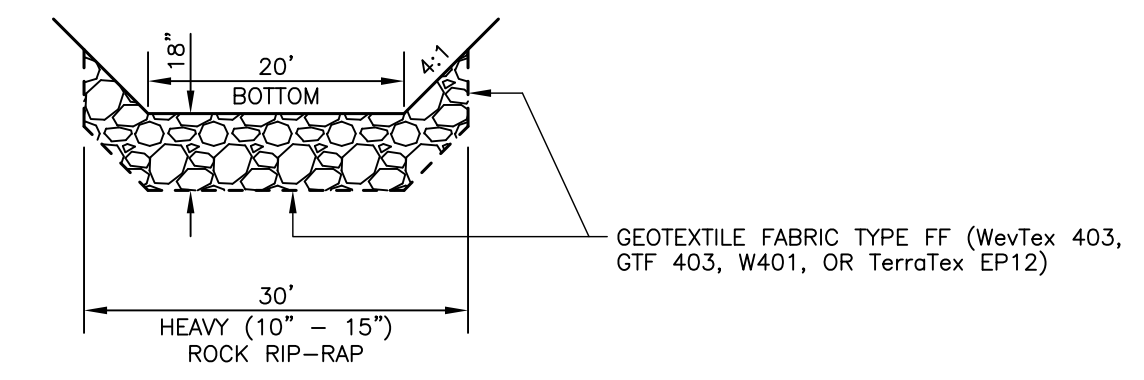

ROCK WATERWAY DETAIL  
NTS

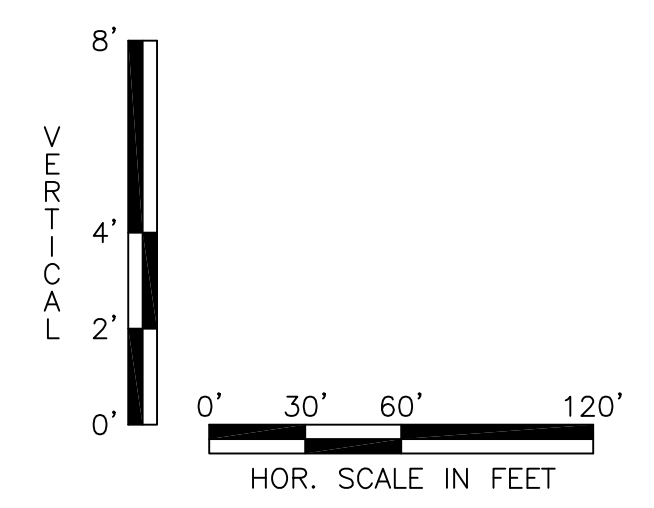

SEEDING  
Apply 80-85 lime at the rate of 2 tons per acre.  
Apply 20-10-10 fertilizer at the rate of 150 pounds per acre.  
Pure live seed per acre mixture:  
Kentucky bluegrass 18.0 lbs/acre  
Creeping Red Fescue 13.5 lbs/acre  
Annual oats 6.0 lbs/acre

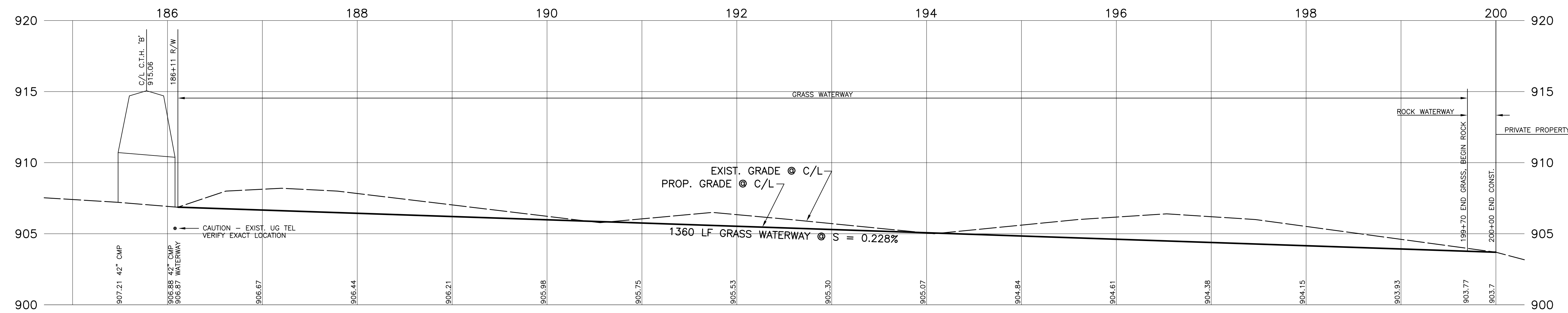

REVISED 5/29/13 DJP

 P.O. Box 293 Beaver Dam, WI 53916 (920) 887-3128 www.dteusa.com © 2013 DesignTech Engineering, LLC.	<b>DODGE COUNTY DRAINAGE DISTRICT 88 OUTLET CHANNEL</b>	
	DRAWN BY: DJP APPROVED: DJP SCALE: GRAPHIC	DATE: APRIL 20, 2013 JOB NO.: dd88

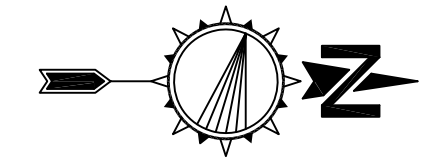

0' 30' 60' 120'  
SCALE IN FEET

42' x 60' CMP  
906.88 IE N.  
907.21 IE S.

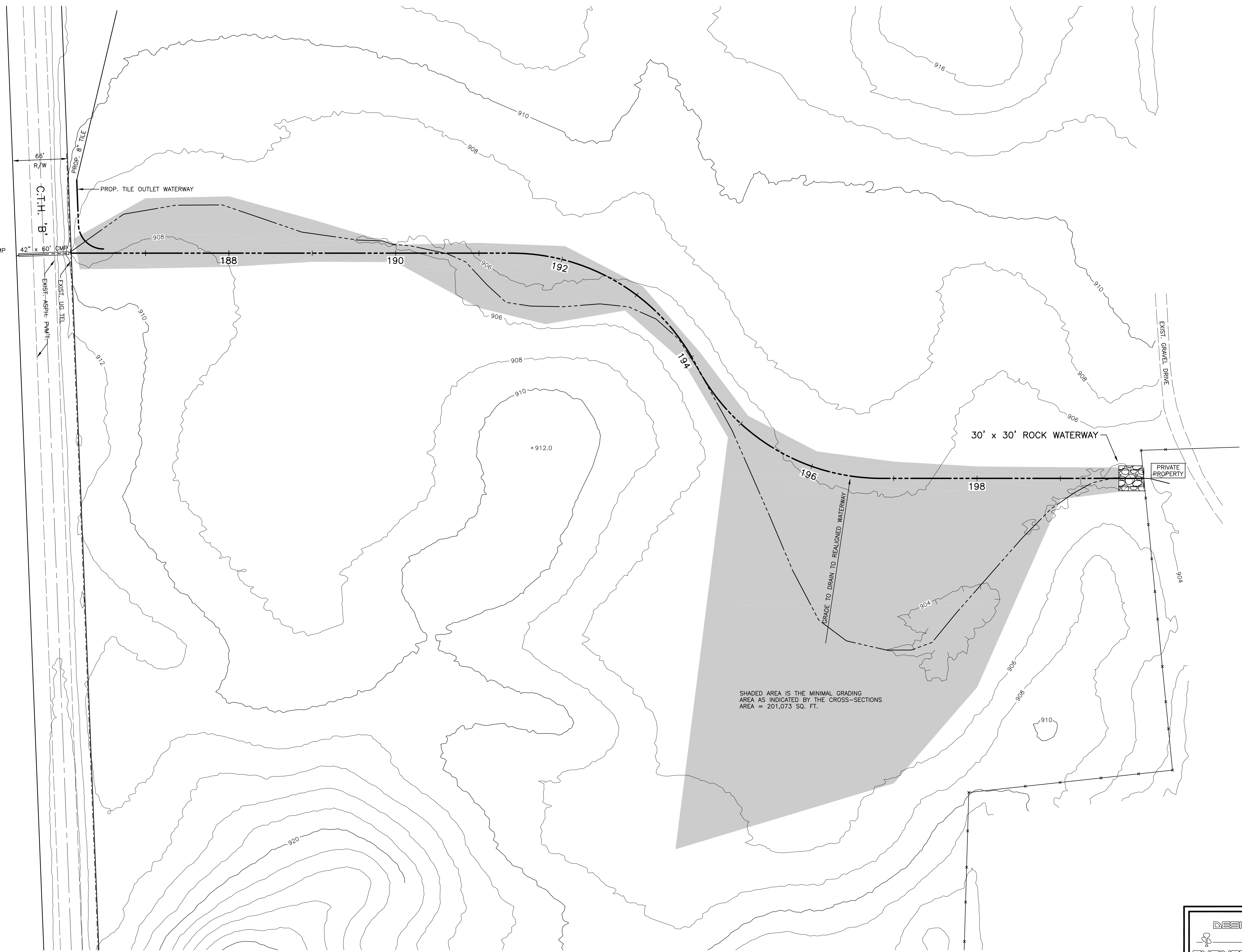

REVISED 5/29/13 DJP

**DESIGNTECH**  
ENGINEERING, LLC

P.O. Box 293  
Beaver Dam, WI 53916  
(920) 887-3128  
www.dteusa.com  
© 2013 DesignTech Engineering, LLC.

<b>DODGE COUNTY DRAINAGE DISTRICT 88 OUTLET CHANNEL TOPOGRAPHY</b>		
DRAWN BY: DJP	DATE	SHEET
APPROVED: DJP	APRIL 20, 2013	<b>3 OF 4</b>
SCALE: GRAPHIC	JOB NO. dd88	

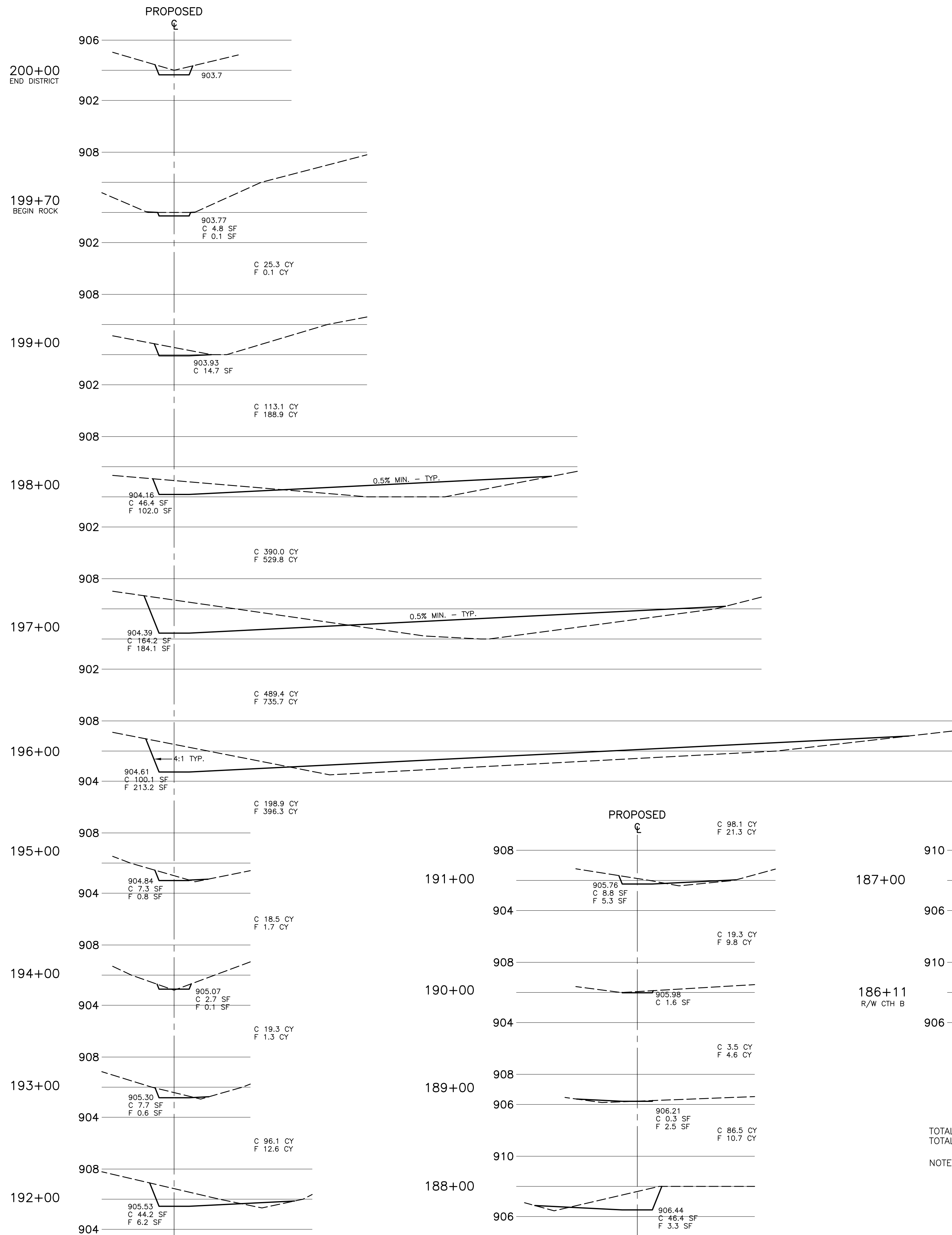

### CHANNEL INSTALLATION NORTH AMERICAN GREEN S150 EROSION NETTING

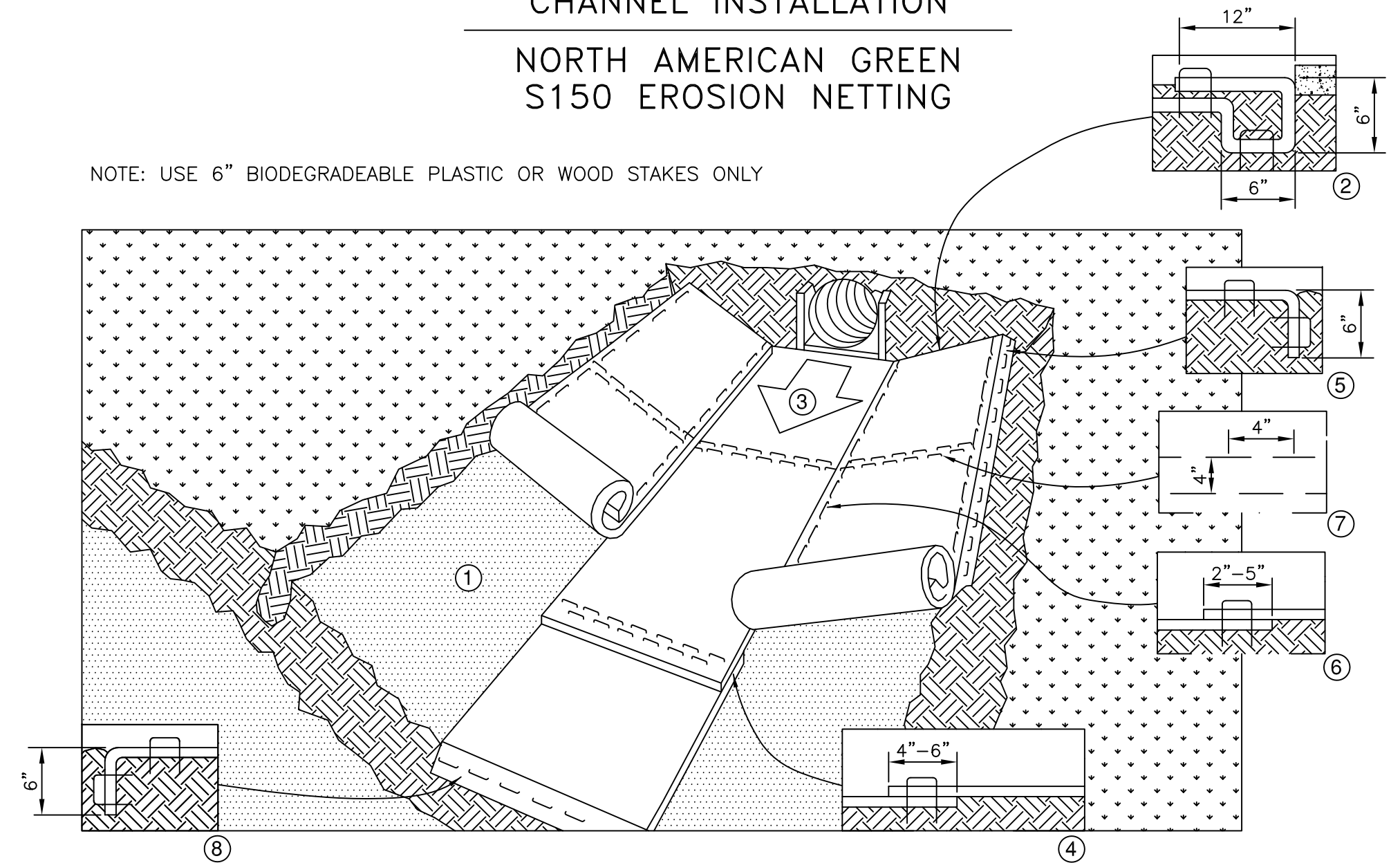

1. PREPARE SOIL BEFORE INSTALLING ROLLED EROSION CONTROL PRODUCTS (RECP's), INCLUDING ANY NECESSARY APPLICATION OF LIME, FERTILIZER, AND SEED.
2. BEGIN AT THE TOP OF THE CHANNEL BY ANCHORING THE RECP's IN A 6" DEEP X 6" WIDE TRENCH WITH APPROXIMATELY 12" OF RECP's EXTENDED BEYOND THE UP-SLOPE PORTION OF THE TRENCH. ANCHOR THE RECP's WITH A ROW OF STAPLES/STAKES APPROXIMATELY 12" APART IN THE BOTTOM OF THE TRENCH. BACKFILL AND COMPACT THE TRENCH AFTER STAPLING. APPLY SEED TO COMPACTED SOIL AND FOLD REMAINING 12" PORTION OF RECP's BACK OVER SEED AND COMPACTED SOIL. SECURE RECP's OVER COMPACTED SOIL WITH A ROW OF STAPLES/STAKES SPACED APPROXIMATELY 12" ACROSS THE WIDTH OF THE RECP's.
3. ROLL CENTER RECP's IN DIRECTION OF WATER FLOW IN BOTTOM OF CHANNEL. RECP's WILL UNROLL WITH APPROPRIATE SIDE AGAINST THE SOIL SURFACE. ALL RECP's MUST BE SECURELY FASTENED TO SOIL SURFACE BY PLACING STAPLES/STAKES IN APPROPRIATE LOCATIONS AS SHOWN IN THE STAPLE PATTERN GUIDE. WHEN USING THE DOT SYSTEM\*, STAPLES/STAKES SHOULD BE PLACED THROUGH EACH OF THE COLORED DOTS CORRESPONDING TO THE APPROPRIATE STAPLE PATTERN.
4. PLACE CONSECUTIVE RECP's END OVER END (SHINGLE STYLE) WITH A 4" - 6" OVERLAP. USE A DOUBLE ROW OF STAPLES STAGGERED 4" APART AND 4" ON CENTER TO SECURE RECP's.
5. FULL LENGTH EDGE OF RECP's AT TOP OF SIDE SLOPES MUST BE ANCHORED WITH A ROW OF STAPLES/STAKES APPROXIMATELY 12" APART IN A 6" DEEP X 6" WIDE TRENCH. BACKFILL AND COMPACT THE TRENCH AFTER STAPLING.
6. ADJACENT RECP's MUST BE OVERLAPPED APPROXIMATELY 2" - 5" (DEPENDING ON RECP's TYPE) AND STAPLED.
7. IN HIGH FLOW CHANNEL APPLICATIONS, A STAPLE CHECK SLOT IS RECOMMENDED AT 30 TO 40 FOOT INTERVALS. USE A DOUBLE ROW OF STAPLES STAGGERED 4" APART AND 4" ON CENTER OVER ENTIRE WIDTH OF THE CHANNEL.
8. THE TERMINAL END OF THE RECP's MUST BE ANCHORED WITH A ROW OF STAPLES/STAKES APPROXIMATELY 12" APART IN A 6" DEEP X 6" WIDE TRENCH. BACKFILL AND COMPACT THE TRENCH AFTER STAPLING.

NOTE:

\* IN LOOSE SOIL CONDITIONS, THE USE OF STAPLE OR STAKE LENGTHS GREATER THAN 6" MAY BE NECESSARY TO PROPERLY ANCHOR THE RECP's.

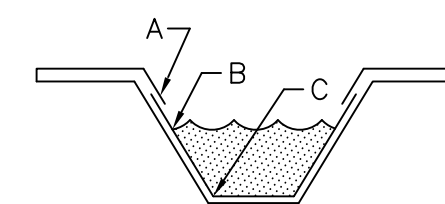

CRITICAL POINTS  
A. OVERLAPS AND SEAMS  
B. PROJECTED WATER LINE  
C. CHANNEL BOTTOM/SIDE SLOPE VERTICES

NOTE:

\* HORIZONTAL STAPLE SPACING SHOULD BE ALTERED IF NECESSARY TO ALLOW STAPLES TO SECURE THE CRITICAL POINTS ALONG THE CHANNEL SURFACE.

\*\* IN LOOSE SOIL CONDITIONS, THE USE OF STAPLE OR STAKE LENGTHS GREATER THAN 6" MAY BE NECESSARY TO PROPERLY ANCHOR THE RECP's.

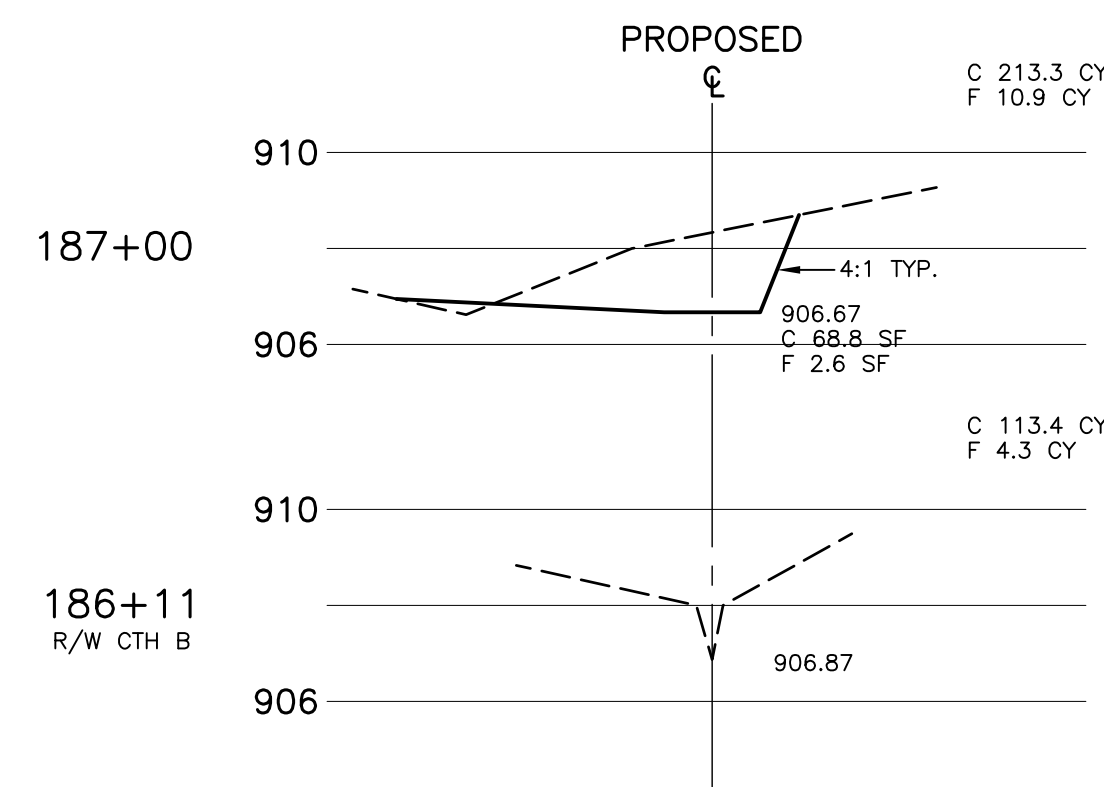
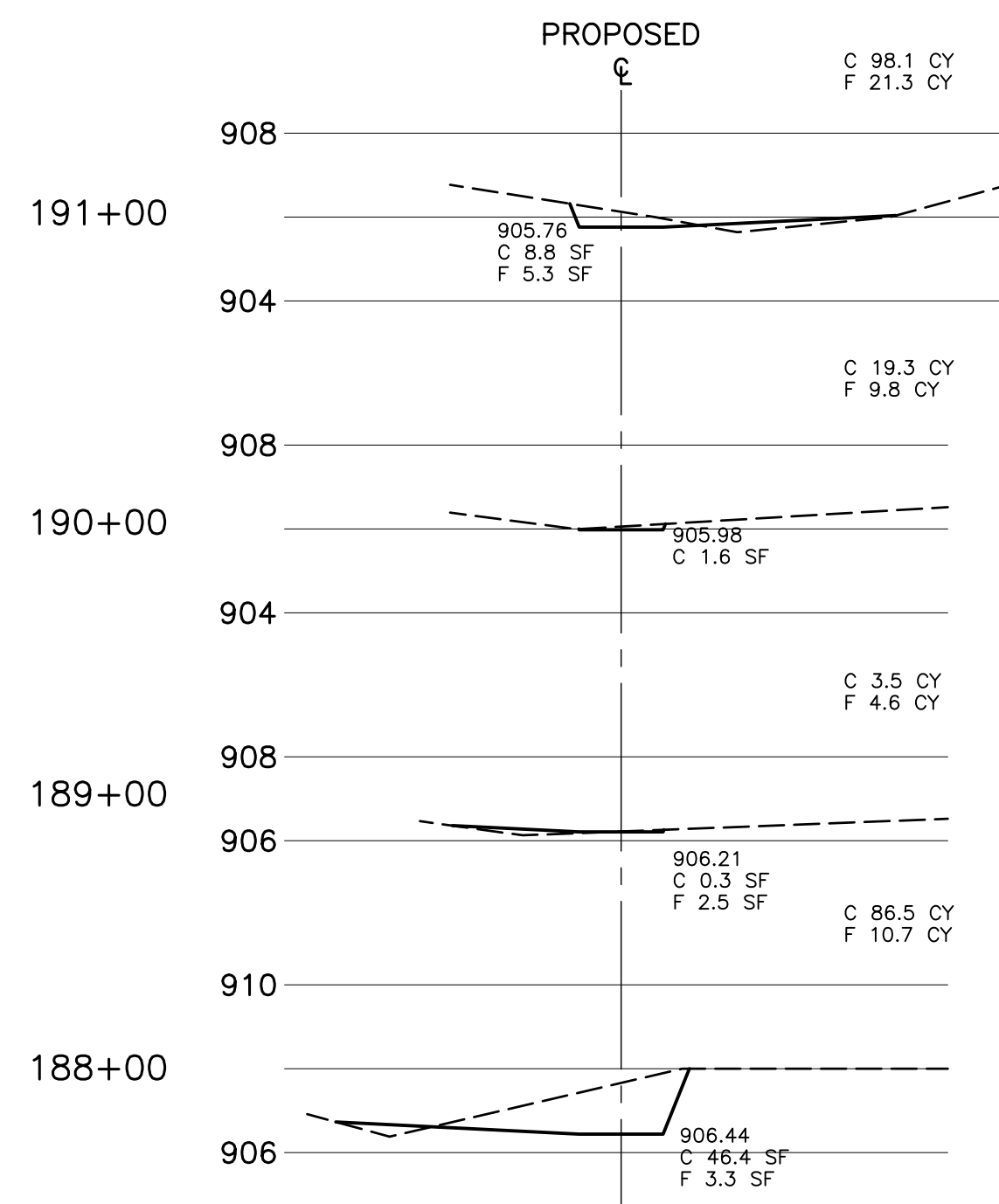

TOTAL GROSS CUT = 1,885 CY  
TOTAL GROSS FILL = 1,928 CY

NOTE: NO PROVISIONS MADE IN ANY QUANTITIES SHOWN ON THIS SHEET FOR TOPSOIL AND COMPACTION

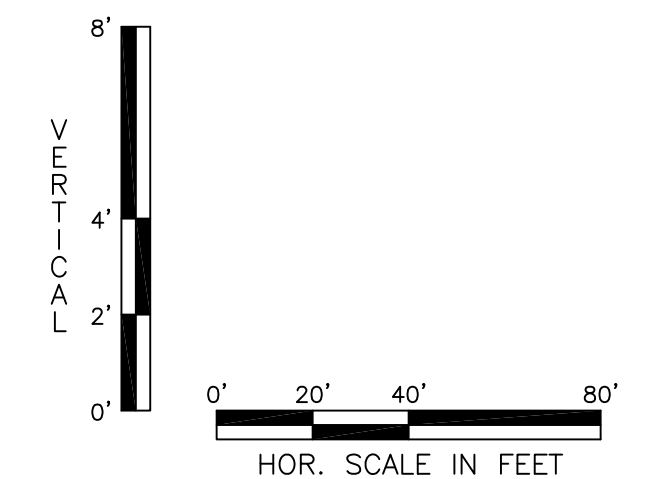

REVISED 5/15/13 DJP

 P.O. Box 293 Beaver Dam, WI 53916 (920) 887-3128 www.dteusa.com © 2013 DesignTech Engineering, LLC.		<b>DODGE COUNTY DRAINAGE DISTRICT 88 OUTLET X-SECTIONS</b>	
		DRAWN BY: DJP APPROVED: DJP SCALE: GRAPHIC	DATE: APRIL 20, 2013 JOB NO.: dd88