

0' 1,000' 2,000'
SCALE IN FEET

DANE COUNTY R. 12 E. JEFFERSON COUNTY R. 13 E.

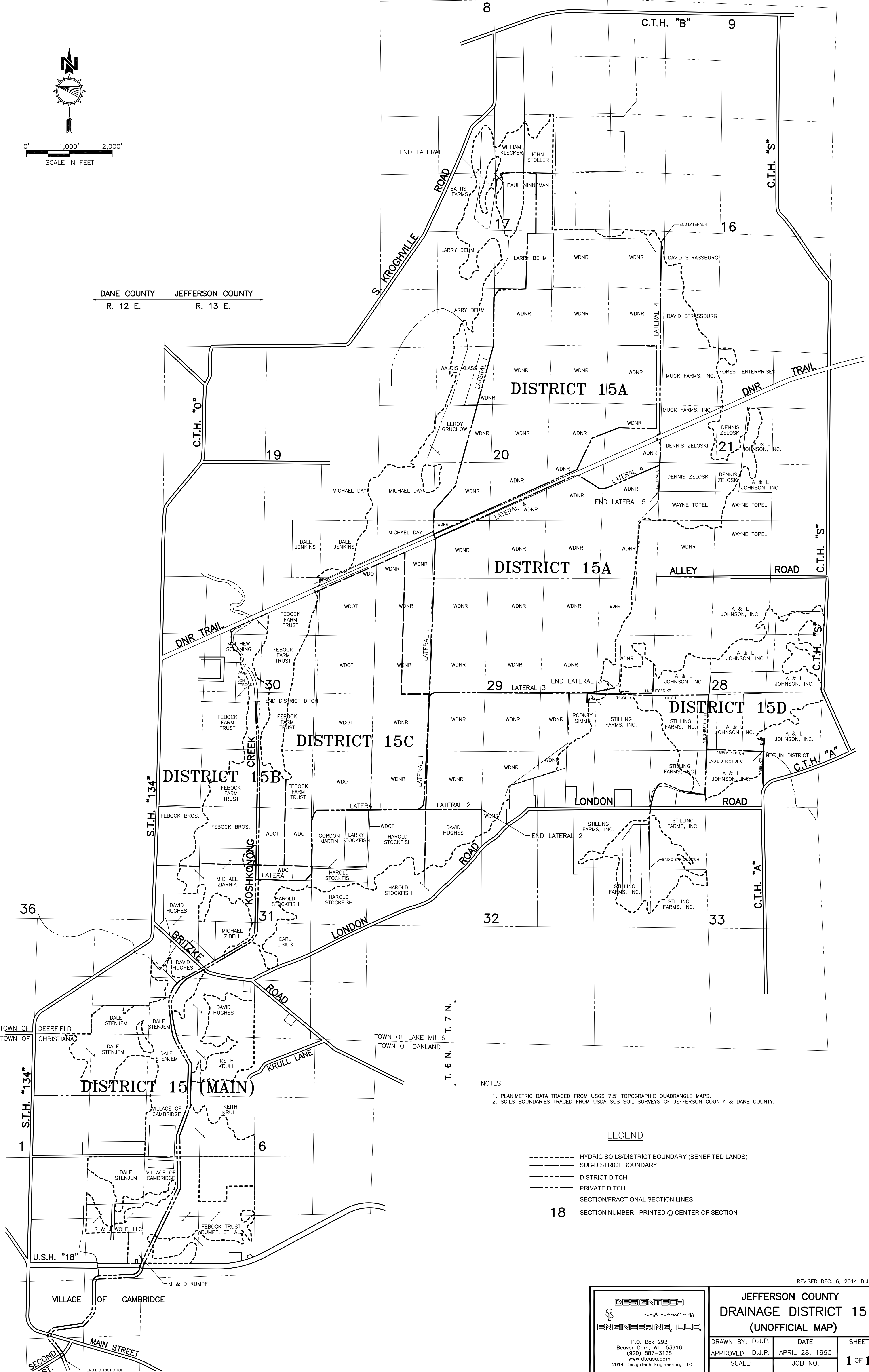

NOTES:
1. PLANIMETRIC DATA TRACED FROM USGS 7.5' TOPOGRAPHIC QUADRANGLE MAPS.
2. SOILS BOUNDARIES TRACED FROM USDA SCS SOIL SURVEYS OF JEFFERSON COUNTY & DANE COUNTY.

LEGEND

- HYDRIC SOILS/DISTRICT BOUNDARY (BENEFITED LANDS)
- SUB-DISTRICT BOUNDARY
- DISTRICT DITCH
- PRIVATE DITCH
- SECTION/FRACTIONAL SECTION LINES
- 18 SECTION NUMBER - PRINTED @ CENTER OF SECTION

REVISED DEC. 6, 2014 D.J.P.

DESIGNTECH
ENGINEERING, LLC

P.O. Box 293
Beaver Dam, WI 53916
(920) 887-3128
www.dteusa.com
2014 DesignTech Engineering, LLC.

**JEFFERSON COUNTY
DRAINAGE DISTRICT 15
(UNOFFICIAL MAP)**

DRAWN BY: D.J.P.	DATE	SHEET
APPROVED: D.J.P.	APRIL 28, 1993	1 OF 1
SCALE:	JOB NO.	
GRAPHIC	JD15	